

smallest controller/driver
available anywhere

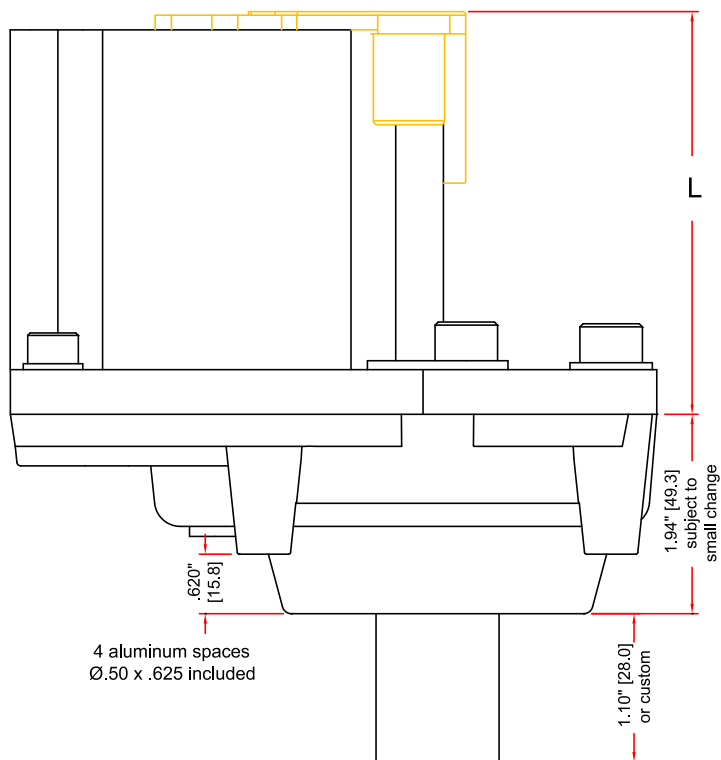

110mm NEMA 42 Stepper Motors with integrated controller and 5:1 Gearhead

- Complete ready-to-run Au110 series motor with strong 5:1 gearhead. Use for automatic assembly, large mills, heavy vertical lifts, or as rotary indexing table.
- Compact size to fit tight spaces, shortest gear box length available.
- Output torque is increased 5X vs. motor torque.
- Output resolution is increased 5X for very high accuracy--2,000 half-steps/revolution.
- Single stage spur gears give give efficiency of 96-97%.
- Advanced technology of machining precision motor pinion gear directly from the stainless steel motor shaft as one integral part--eliminates keyways, screws, clamps, adhesives, etc.
- Gear Backlash is near zero, and is adjustable. Gears are quiet running and have long life, and are more economical than planetary gears.
- Light weight--only 6.4lbs for the gearhead allows faster moving mechanisms.
- Exact same gearhead for any of the AuG110 series motors, only the motor length is different.
- Various methods for mounting to your plate and mechanism.
- Save time and money by specifying your custom output shafts, for a nominal charge. We can even add gears, pulleys, leadscrews, shaft couplers.

shortest gearhead
in the world!

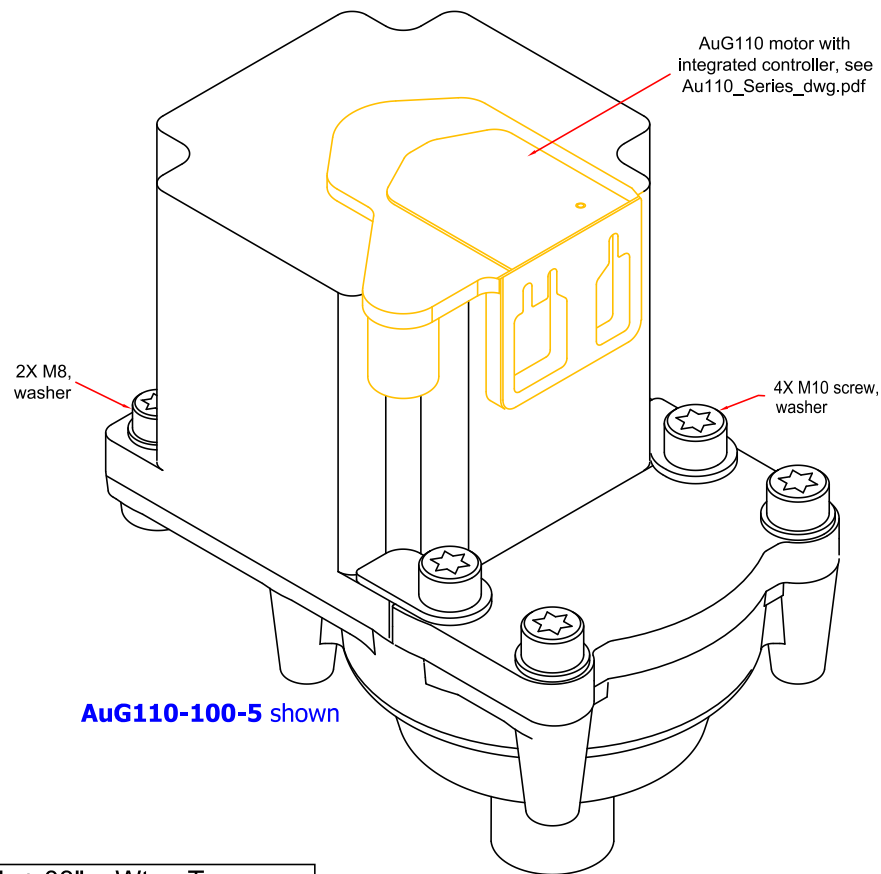

AuG110-100-5 shown

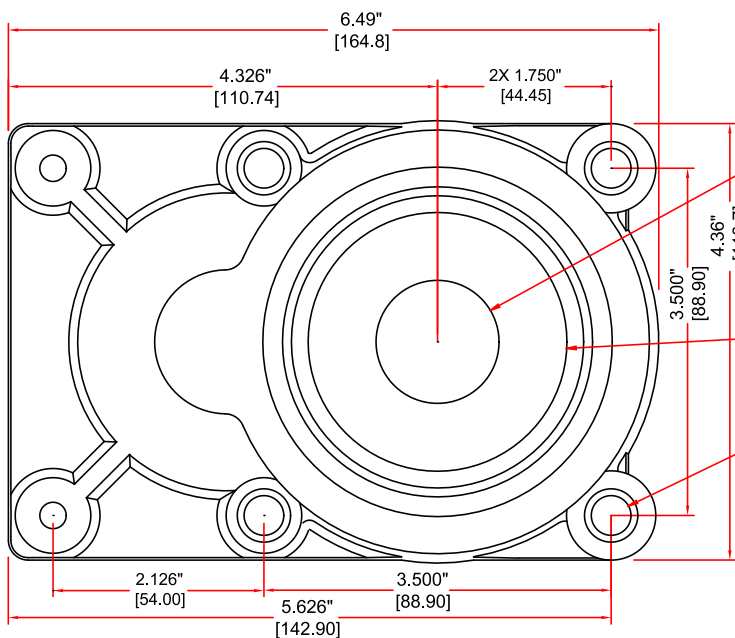

Output Shaft
?1.1811" [?30.000],
can be custom machined
to your specifications

Massive dual row angular
contact ball bearing 5306-2RS
static load rating is 26KN
(6,000 lbs)

4X M10 threads

Motor/gear	L ±.03"	Wt.	Torque
AuG110-100-5	4.00"	14.5lb	500 in-lb
AuG110-150-5	6.02	23.0	1,000
AuG110-180-5	7.15	28.5	1,450